



THE NORMAL TRAFFIC PATTERN ON THIS ALLEY IS FROM EAST TO WEST (ONE WAY). HOWEVER, DURING CONSTRUCTION THIS PATTERN WILL BE CHANGED TO ALLOW TRAFFIC TO ENTER AND EXIT FROM NORTH PEARL STREET (TWO WAY).

THE NORMAL TRAFFIC PATTERN ON THIS ALLEY IS FROM EAST TO WEST (ONE WAY). HOWEVER, DURING CONSTRUCTION THIS PATTERN WILL BE CHANGED TO ALLOW TRAFFIC TO ENTER AND EXIT FROM W. NORTH WATER STREET (TWO WAY).

NOTE: THE CONTRACTOR SHALL BE SENSITIVE TO THE TRAFFIC FLOW IN THE ALLEY AND THE NECESSITY FOR REAR ACCESS TO THE ADJACENT BUILDINGS. WORK ACTIVITIES SHALL BE SCHEDULED AND COORDINATED WITH LOCAL BUSINESSES AND RESIDENTS TO MINIMIZE PROPERTY ACCESS ISSUES (INCIDENTAL TO CONSTRUCTION).

**LEGEND**

- ↓ TYPE III BARRICADE
- ↑ TYPE III BARRICADE WITH ATTACHED SIGN
- TRAFFIC CONTROL DRUM
- ⚡ TRAFFIC CONTROL DRUM WITH TYPE C STEADY BURN LIGHT
- ⚡ SIGN ON TEMPORARY SUPPORT
- ▬ CONCRETE BARRIER TEMPORARY PRECAST
- ▨ WORK AREA
- 🚧 FLAGGER, EQUIPPED WITH STOP/SLOW PADDLE FASTENED ON SUPPORT STAFF
- DIRECTION OF TRAFFIC

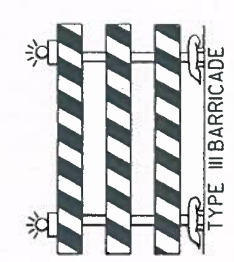
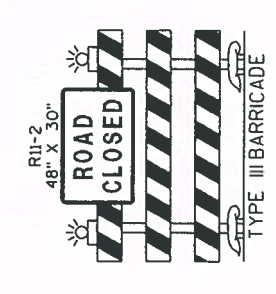

PROJECT NO.	SCALE	DATE	BY
08001005	AS SHOWN	11/11/2016	M.L.
08001005	AS SHOWN	11/11/2016	M.L.
08001005	AS SHOWN	11/11/2016	M.L.

**MSA**  
PROFESSIONAL SERVICES  
ARCHITECTURE | ENGINEERING | ENVIRONMENTAL  
PLANNING | PLANNING | SURVEYING  
201 Corporate Drive Beaver Dam, WI 53916  
(920) 887-4242 (800) 552-6330  
www.msa-ps.com

**RIVER WALL REHABILITATION PROJECT**  
WOLF RIVER (State Street to N. Pearl Street)  
CITY OF NEW LONDON, WAUPACA COUNTY, WI

**TRAFFIC CONTROL - STAGE 3**

DATE: 11/11/2016  
DRAWN BY: M.L.  
CHECKED BY: M.L.  
SCALE: AS SHOWN